

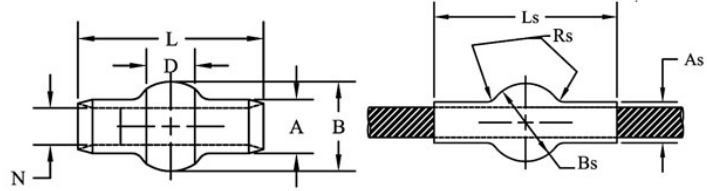

The MS20663 Series double shank balls are manufactured from Military Specification Stainless Steel to the strict standards of the MS20663, and are certified to that standard. Loos Cableware® Division offers a full line of sizes.

MIL-DTL-781: **YES**  
MADE IN THE USA: **YES**  
DFARS COMPLIANT: **YES**



MS Part Number	Cable Dia.	A Dia.	As Dia.	B Dia.	Bs Spherical Dia.	D Ref.	L± .0075	Ls Ref.	N Dia.	Rs Rad. Ref.	Lbs. Per Piece
MS20663C2*	1/16	0.127	0.112	0.207	0.19	0.114	0.362	0.39	0.073	0.014	0.0016
MS20663C3*	3/32	0.163	0.143	0.277	0.253	0.152	0.525	0.578	0.104	0.019	0.0032
MS20663C4*	1/8	0.218	0.19	0.345	0.315	0.1895	0.688	0.765	0.139	0.023	0.0094
MS20663C5*	5/32	0.254	0.222	0.419	0.379	0.227	0.85	0.953	0.169	0.028	0.0125
MS20663C6*	3/16	0.293	0.255	0.487	0.442	0.264	1.012	1.14	0.201	0.033	0.025
MS20663C7*	7/32	0.347	0.302	0.555	0.505	0.3025	1.175	1.328	0.233	0.038	0.032
MS20663C8*	1/4	0.401	0.348	0.624	0.567	0.3395	1.337	1.515	0.264	0.042	0.04
MS20663C9*	9/32	0.439	0.382	0.694	0.632	0.3775	1.497	1.719	0.297	0.046	0.042
MS20663C10*	5/16	0.475	0.413	0.763	0.694	0.4145	1.664	1.875	0.328	0.046	0.043

\*Denotes stock item



The MS20664 Series single shank balls are manufactured from stainless steel in accordance with MIL-DTL-781 to the strict standards of the MS20664, and are certified to that standard. Loos Cableware® Division offers a full line of sizes.

Loos Cableware Division offers a full range of sizes in its single shank stainless steel ball series of parts. Single shank ball series are a very versatile cable end fittings that has many uses and applications when cable must be terminated with a swage fitting that will exceed the minimum breaking strength of the cable on to which it is swaged.

MIL-DTL-781: **YES**  
 MADE IN THE USA: **YES**  
 DFARS COMPLIANT: **YES**

MS Part Number	Cable Dia.	A Dia.	As Dia.	B Dia.	Bs Spherical Dia.	Cs Ref	D Ref.	E Rad Ref	L	N Dia.	Rs Rad. Ref.	Lbs. Per Piece
664-C1.5*	3/64	.132	.112	.212	.160	.156	.114	.0825	.2685	.053	.014	.00132
MS20664C2	1/16	.132	.112	.212	.190	.156	.114	.0825	.2685	.073	.014	.0019
MS20664C3	3/32	.168	.143	.282	.253	.234	.152	.110	.384	.104	.019	.005
MS20664C4	1/8	.223	.190	.350	.315	.313	.1895	.137	.500	.139	.023	.0075
MS20664C5	5/32	.259	.222	.424	.379	.391	.2275	.165	.616	.169	.028	.01
MS20664C6	3/16	.298	.255	.492	.442	.469	.2645	.192	.730	.201	.033	.015
MS20664C7	7/32	.352	.302	.560	.505	.547	.3025	.220	.846	.233	.038	.025
MS20664C8	1/4	.406	.348	.629	.567	.625	.3395	.2447	.962	.264	.042	.03
MS20664C9	9/32	.444	.382	.699	.632	.750	.3775	.275	1.078	.297	.046	.05
MS20664C10	5/16	.480	.413	.768	.694	.813	.4145	.302	1.193	.328	.046	.066
664C12*	3/8	.553	.476	.903	.820	.935	.489	.357	1.425	.411	.061	.0874

\*Item is NOT military-specification. All without asterisk are.

